

Compact Car Jump Starter

Peak Current: 800A Capacity: 15000mAh



Model: iS-15000



TECHNICAL SPECIFICATION:

Input: 14V1A

Output: 5V/2A; 5V/1A; 12V10A; 19V/3.5A
12V Jump start
LED light (light, burst flashing, SOS)

Start Current: 400A

Peak Current: 800A

Size: 157*75*36mm

Weight: 530g Capacity: 15000mAh

Operating Temp.: -20℃ ~60℃/-4°F ~140°F

Lifetime: >1000 cycles

ACCESSORIES:

Home charger*1	Jumper Cable*1
Car charger*1	3 in 1 Mobile connectors*1 (Micro, iP4, iP5)
Laptop connectors*8+switch cable*1	



Packing: Color Box + PU bag

FEATURES:

1. Powerful capability for jump Start 12V vehicle.
2. Supply power for 19V laptop.
3. Supply power for Mobile, Tablet PC, MP3/MP4, PSP, Camera and other digital devices.
4. Supply power for car refrigerator, blast pump, and other 12V devices.
5. LED light (light, burst flashing, SOS)

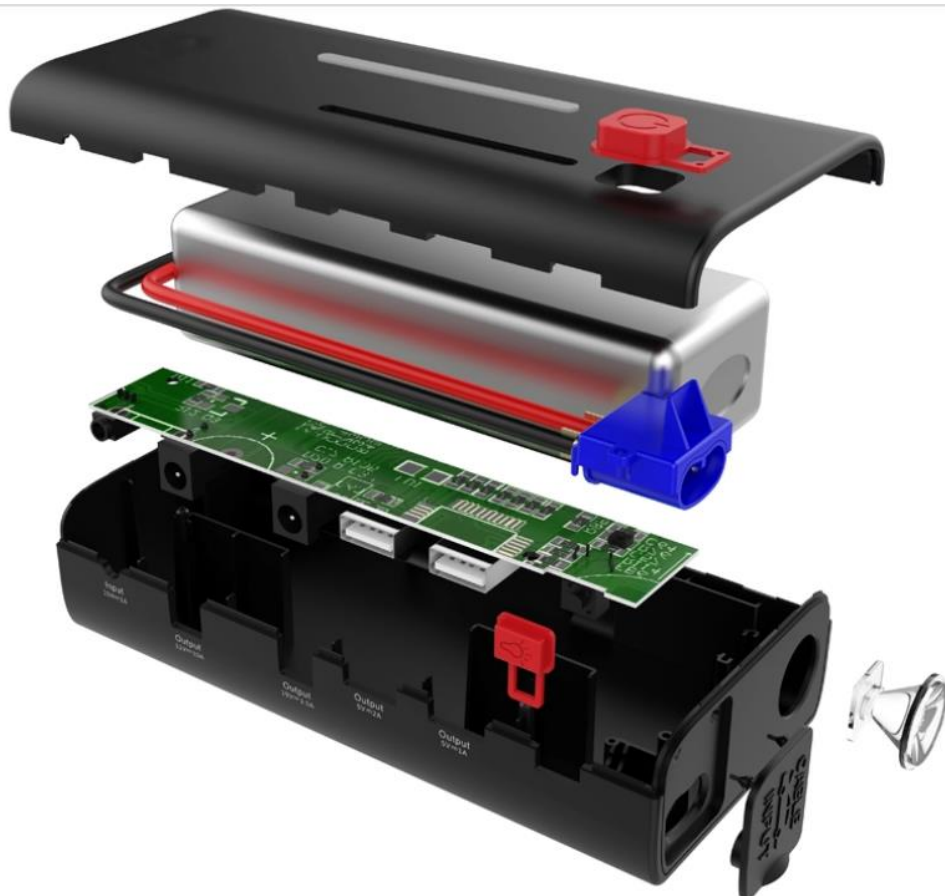

specification:

Model No.	Item	Parmater	Priority
iS-15000	Product name	Jump starter	New line, beginning from last year
	Battery Material	Li-polymer	Long usful time around 3-5 years, enviromental protention
	Components and IC	Import from U.S.A.	High quality warranty
	Battery Capacity	15000mAh	Big capacity can jump start vehicle around 10-20 times and long standby time around 1 year
	Quality Grade	A	Quick charing time around 2-3 hours
	Input	14V/1A	
	Output	5V/1A;19V/3.5A;12V/10A;5V/2A;Light;	Wide usage scope
	Start Current	400A	
	Peak Current	800A	
	Operation Temperature	0°C~60°C/32°F~140°F	It is okay to use in cold weather and high-temperature enviroment, no bombing happened.
	Weight	530g	Light weight, portable carrying
	Dimension(L*W*H)	157*75*36mm	Small size, portable carrying
	Cycle times	>1000cycles	Many times
	Certificate	FCC,CE,ROHS,RCM , CEC	High quality meet with the required standard
	Patent	Patent of outlook design and utility model from SIPO	Patent devoid copy and protect sales market
	Usage Scope	1.Jump start 12 V vehicle 2. Power supply for Mobile phone, MID, LAPTOP,PSP, Cooler boxes, MP3/MP4 3. Torch function 4. Warning Flashing 5. SOS function	